



Sandridge House, 4 Gibbs Close

Harpenden, AL5 1FA

Superbly presented and incredibly spacious ground floor apartment within this modern development built 6 years ago. The property benefits from a large private terrace, access to communal gardens and two underground parking spaces accessed via a lift. Located moments from both the High Street and the Common and a short walk to the station. * CHAIN FREE *

Guide price £895,000

Sandridge House, 4 Gibbs Close

Harpenden, AL5 1FA



- Superbly presented and generously proportioned apartment
- 2 underground parking spaces
- CHAIN FREE
- Ground floor
- Moments from both the High Street and the Common
- Service Charge £4,136.00 pa
- Large private terrace
- Council Tax Band G
- Ground Rent £650.00 pa

Entrance Hall

Bathroom

Kitchen/Living/Dining Room

33'8" x 18'6" (10.27m x 5.64m)

Utility Room

10'3" x 6'9" (3.14m x 2.06m)

Study Area

8'2" x 6'9" (2.50m x 2.06m)

Bedroom One

13'11" max x 12'6" (4.26m max x 3.82m)

Dressing Area

7'10" x 7'6" (2.41m x 2.29m)

En-suite Bath and Shower

Bedroom Two

14'2" x 10'4" (4.32m x 3.15m)

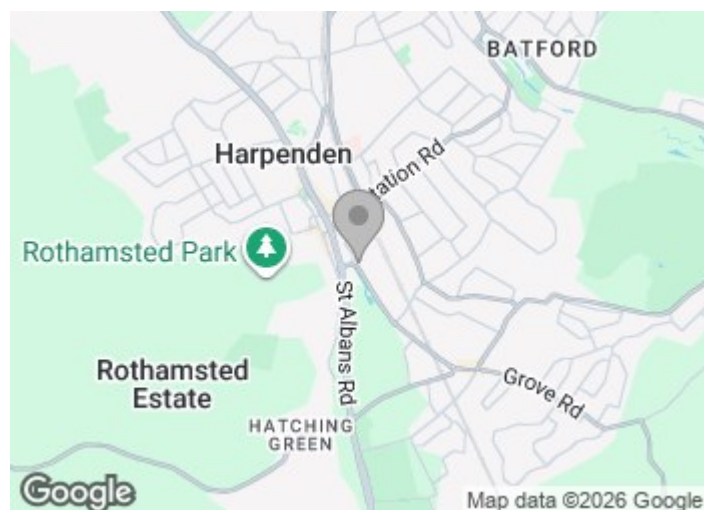



Floor Plan

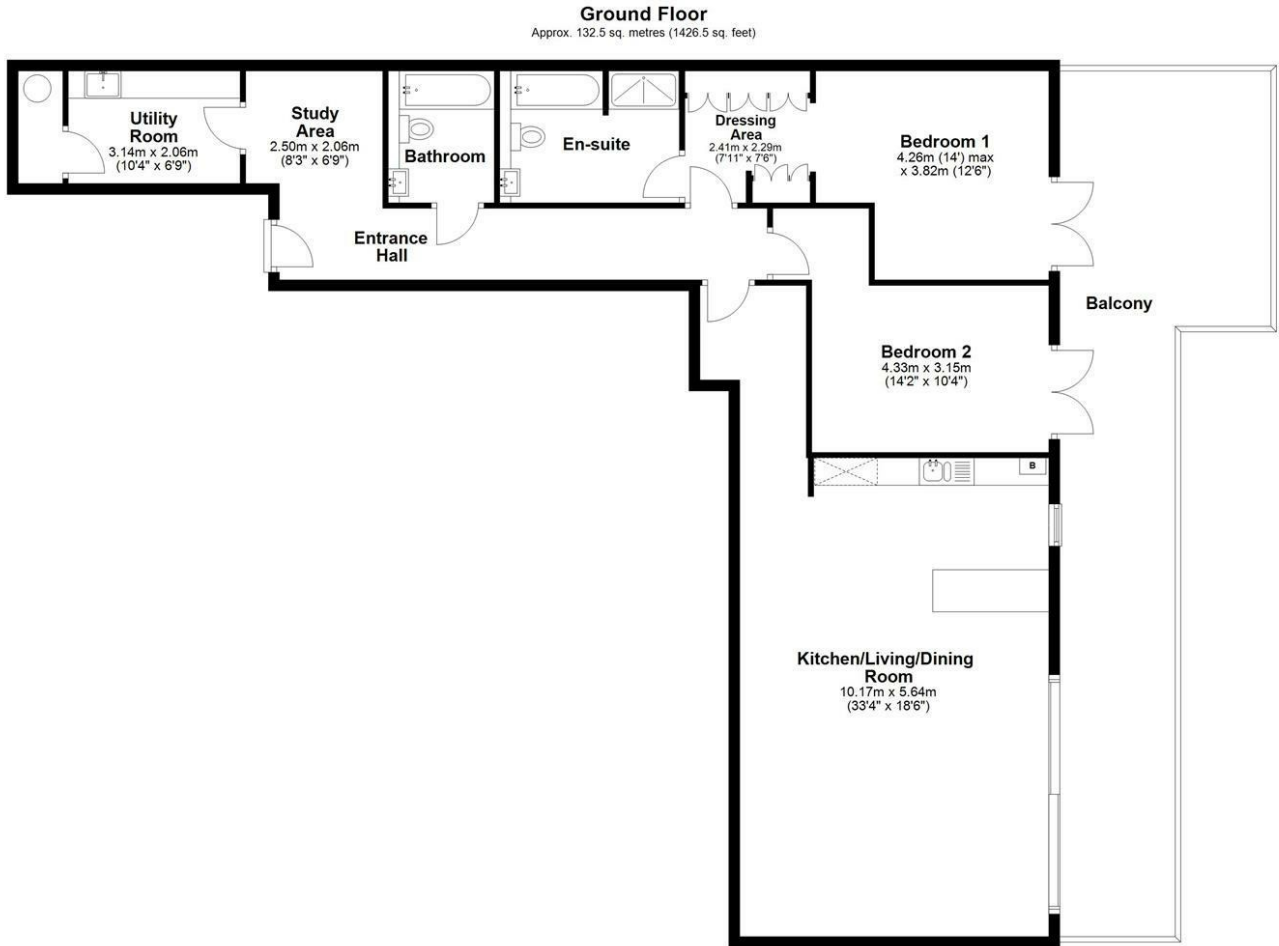

Total area: approx. 132.5 sq. metres (1426.5 sq. feet)

Sketch layout only. Not to scale. Plan produced for Whittaker & Co.

Plan produced using PlanUp.

These particulars, whilst believed to be accurate are set out as a general outline only for guidance and do not constitute any part of an offer or contract. Intending purchasers should not rely on them as statements of representation of fact, but must satisfy themselves by inspection or otherwise as to their accuracy. No person in this firm's employment has the authority to make or give any representation or warranty in respect of the property.

